

4

3

2

1

NOTES: (UNLESS OTHERWISE SPECIFIED)

- 1. INTERPRET DRAWING IN ACCORDANCE WITH ASME Y14.5-1994.
- 2. MATERIAL: C110 COPPER ALLOY.
- 3. FINISH: 3µm [120µ"] MIN MATTE TIN (LEAD FREE) OVER 1.3µm [50µ"] NICKEL.
- 4. PARTS TO BE SUPPLIED ON A CONTINUOUS REEL.
- 5. RECOMMENDED IMMERSION TIN PCB HOLE SIZES;

INSERTION PCB:
 DRILL: Ø1.151±0.025 [.0453±.0010]
 Cu HOLE: Ø1.041±0.051 [.041±.002]
 Sn HOLE: Ø 1.02 [.040] REF

REV	REVISION RECORD	ECN	BY	APVD	DATE
A	INITIAL RELEASE PER EWR 106433	505730	RJB	RJB	03/25/09

F

E

D

C

B

A

F

E

D

C

B

A

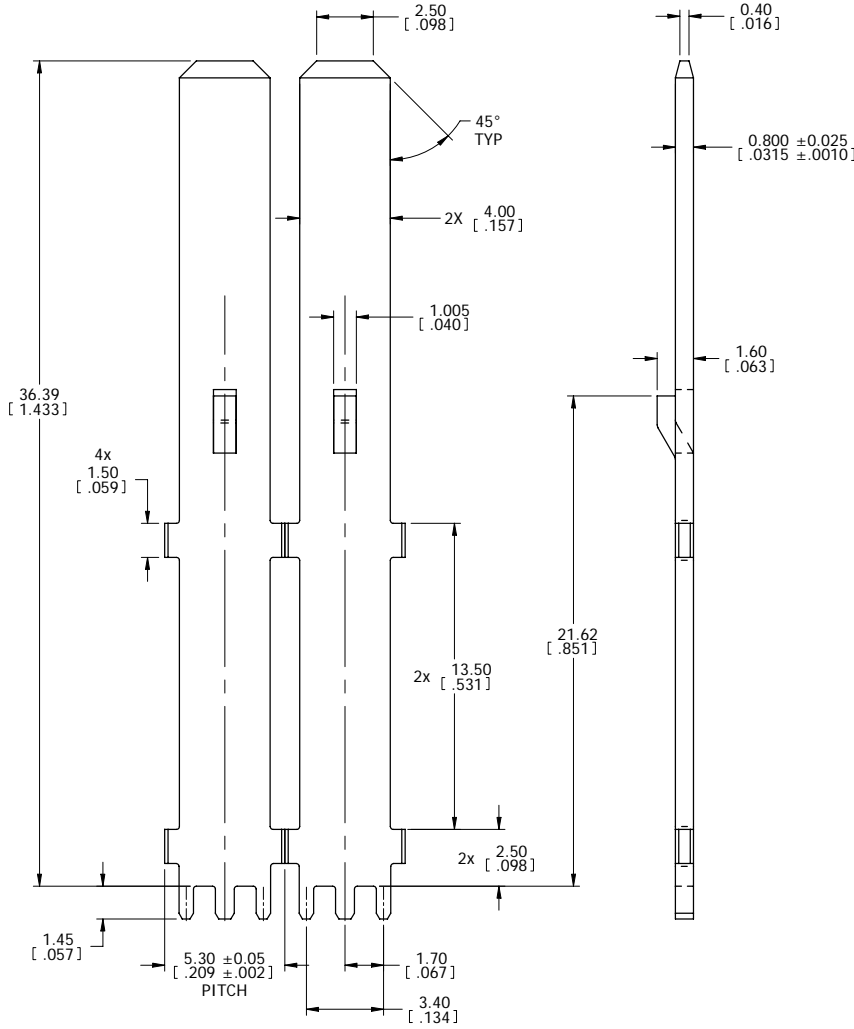
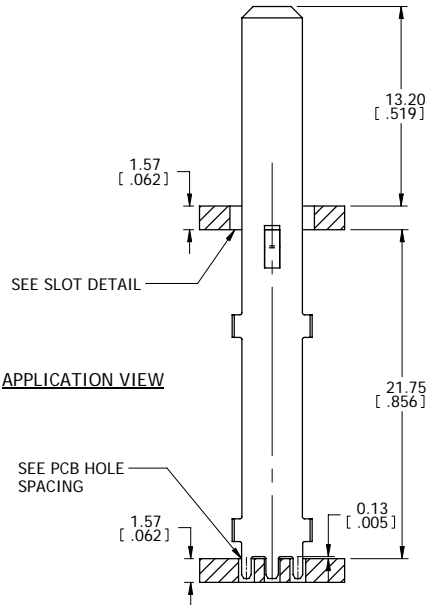

WINDING INSTRUCTIONS:

- 1. RIGHT SIDE FEED.
- 2. BOARD STOP FEATURE, REEL OUT.

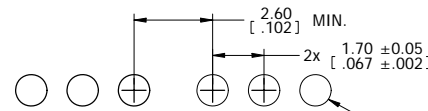
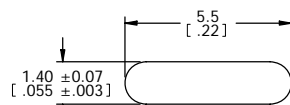
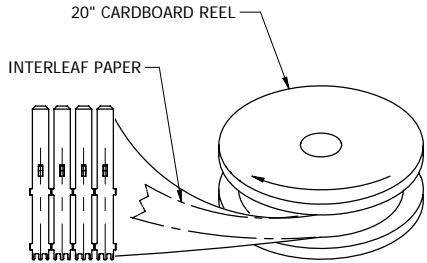

**CONFIDENTIAL
CUSTOMER DRAWING**

TOLERANCES UNLESS OTHERWISE SPECIFIED DIMENSIONS IN mm (INCHES)				AutosplICE, Inc. 10121 Barnes Canyon Rd. San Diego, CA 92121-2725 858.585.0077
DECIMAL: X.X = ±0.3 [.XX] = ±[.01] X.XX = ±0.13 [.XXX] = ±[.005]		ENGINEERED BY: Badger DATE: 8/12/08	DRAWING NUMBER: Badger DATE: 8/12/08	TITLE: 3 LEG STANDOFF, 0.8mm THICK
ANGULAR: ±5°	DENOTES SPECIAL CHARACTERISTIC	SIZE: C SPEC NO: OAE89	DRAWING NUMBER: C7-V1109-001TT	REVISION: A
SCALE 10:1		P&ID NO: C7-V1109-001TT.a.dtl	MODEL NO: 7-V1109-001.pwr	SHEET 1 OF 1

The drawing and the information set forth hereon are the property of AutosplICE, Inc. and are to be held in trust and confidence. Publication, disclosure, or use for any purpose not expressly authorizing in writing by AutosplICE, Inc. is prohibited.

4

3

2

1